

CODING KEY TOOL

Quantity: 1

CODING KEY STARS

Quantity: 10

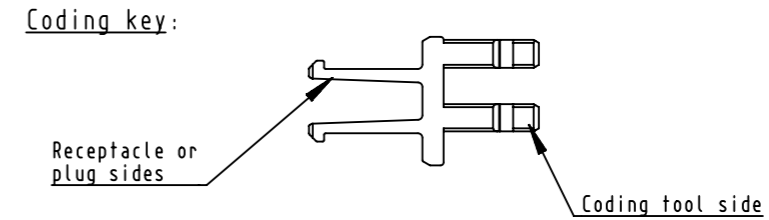
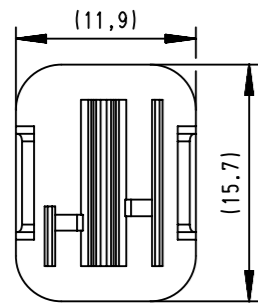
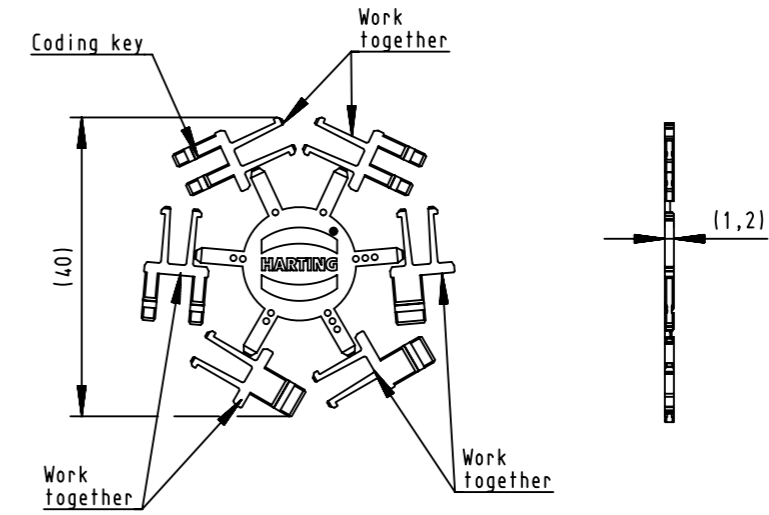
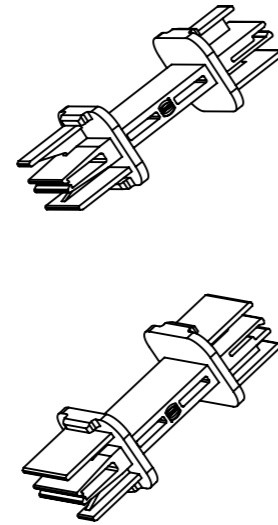
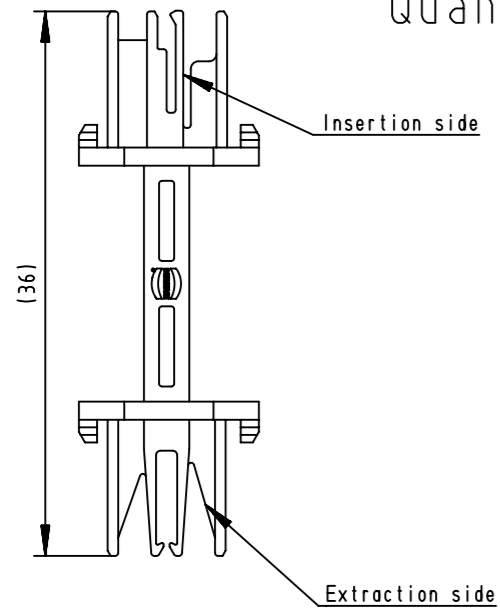

KEYING ON CODING KEY TOOL

Keying area: V shape of receptacle or plug shell MUST be on this coding key tool side

RECEPTACLE

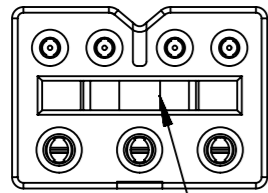

Areas for coding key

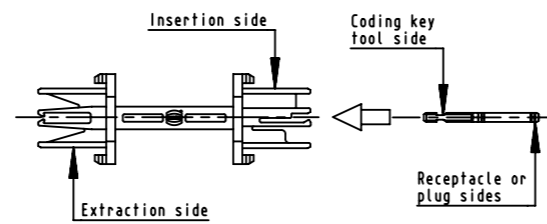
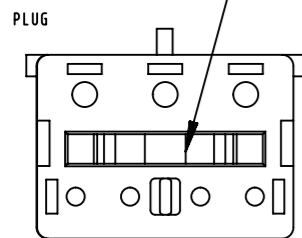

For coding key insertion: coding key is inserted in tool insertion side
 For coding key extraction: coding key is inserted in tool extraction side
 Coding key is locked inside counterpart after hearing CLICK sound

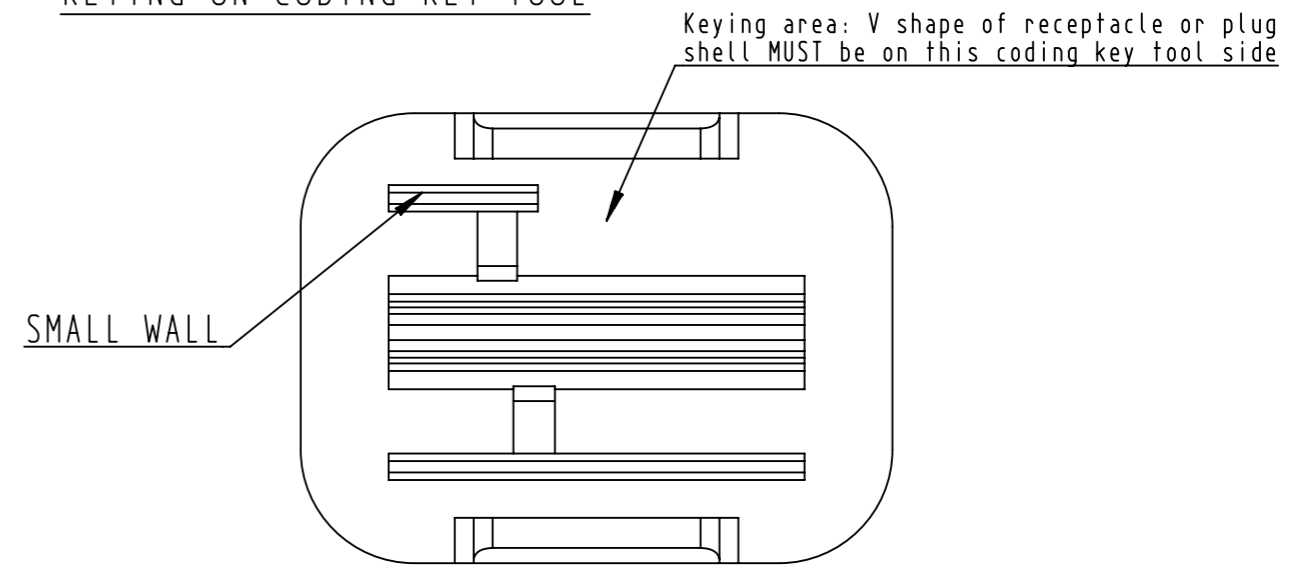
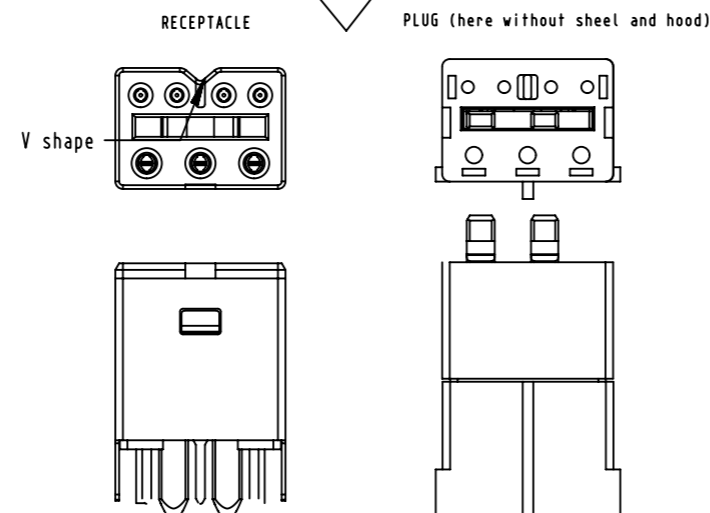

Coating	A=	mm ²	V=	mm ²	m=	g	Mat.
	All Dimensions in mm Original Size DIN A3		Scale 1:1	Free size tol.		Ref. Sub.	
	All rights reserved Department EC PD - FR		Created by BARLEMONT	Inspected by DE VANSAY	Standardisation HOFFMANN	Date 2013-02-08	State Final Release
HARTING Electronics GmbH D-32339 Espelkamp			Title HPP V4 Hybrid coding key set			Doc-Key / ECH-Nr. 100178556/UGD/001/C	
			Type TB	Number 09458451300		Rev. C	Page 1/1