

1972

NUMBER 421336

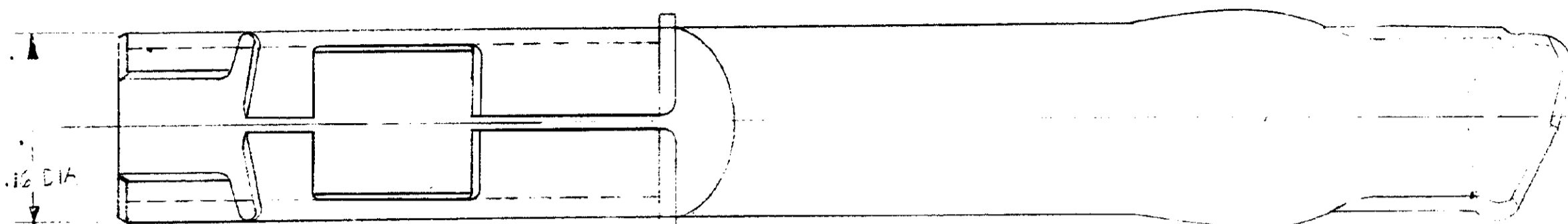

.74

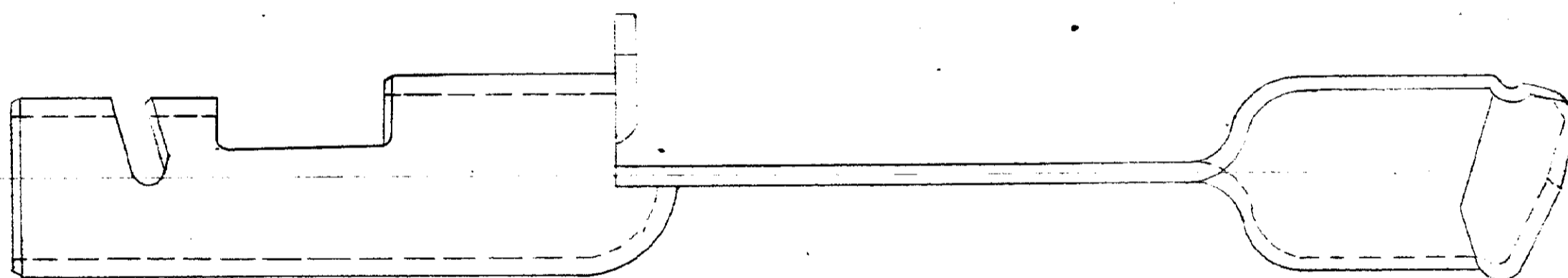

1.20

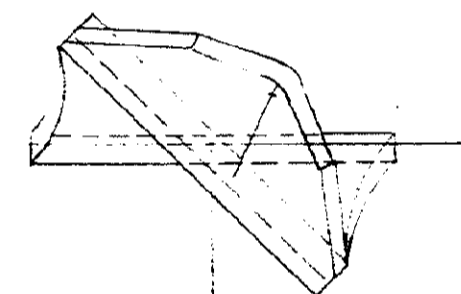

| | |
|----------|---------|
| 421336-7 | GOLD |
| 421336-2 | TIN |
| PART NO. | PLATING |

| REV | DATE | DESCRIPTION | BY | CHK |
|-----|--------|-----------------|----|-----|
| A | 9-9-70 | -7 WAS -3 | | |
| O | 9-9-70 | RELEASE TO CUST | | |

| | | | | | | |
|-----------------------|--|------------------|----------------------------|--------------------|---|--------------------|
| REQUIRED PER ASSEMBLY | | DWG SIZE | NUMBER | NAME | REMARKS | ITEM NO. |
| | | MATERIAL | FINE GRAIN BRASS | HEAT TREAT | SEE ABOVE | |
| | | WIRE RANGE | UNLESS OTHERWISE SPECIFIED | | REMOVE BURRS, BREAK SHARP EDGES .015 R MAX | |
| | | AREA | SPECIFIED | | DECIMALS: .00 ± .02, .000 ± .005, .0000 ± .0005 | J |
| | | CLASS | TYPE | | LANCER LOK | |
| | | DR | E. Zimmerman | | 9-9-70 | |
| | | CHK | Bill Baker | | 9-9-70 | |
| | | APP | Leon Yocum | | 9/4/70 | |
| | | REL | | | | |
| | | SCALE | NAME | | 10:1 | SPRING - LEFT HAND |
| | | AMP INCORPORATED | | HARRISBURG, PENNA. | | |
| | | LOC | SC | | 421336 | REV A |

CUSTOMER DRAWING

DIMENSIONS IN INCHES. DO NOT SCALE PRINT.

12